

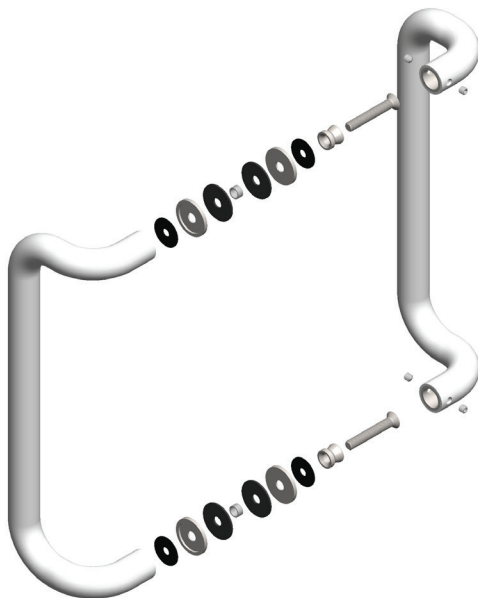

PL3EO18 Glass Mounted Offset Style Handle

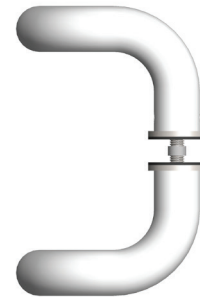
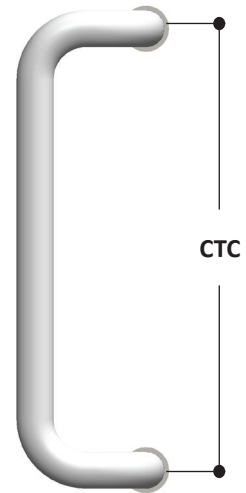
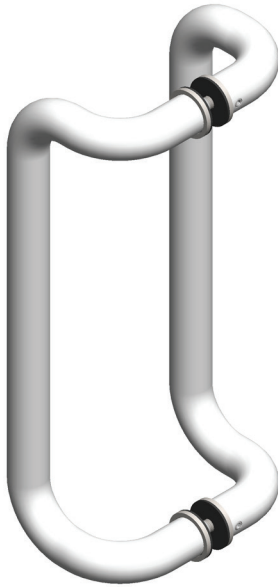

CAT. NO.	CTC	FINISH
PL3EO18BS	18"	Brushed Stainless Steel
PL3EO18PS	18"	Polished Stainless Steel
PL3EO18SB	18"	Satin Brass
PL3EO18PB	18"	Polished Brass
Back To Back Handles		
Glass Hole Required: 5/8" Diameter		
Construction: 1" Diameter Stainless Steel or Brass Tubing		
Glass Thickness: 3/8" to 3/4"		
Extra Bolts Included for 1-3/4" Aluminum Door		
Bolt Spec: M8x1.25		
3mm Hex Key / Allen Wrench Included		