

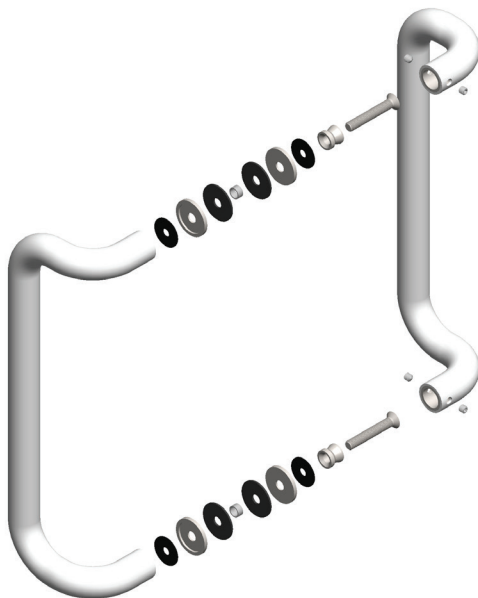

**PL3EO12** Glass Mounted Offset Style Handle

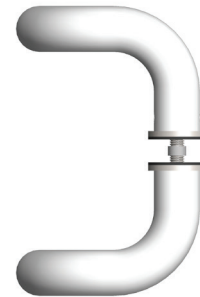
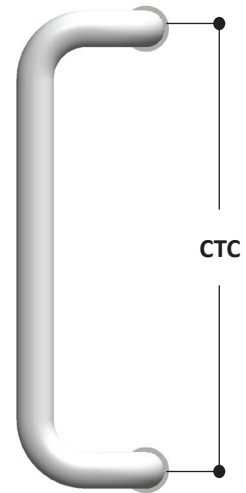
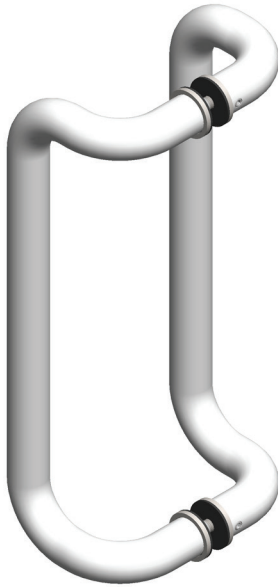

CAT. NO.	CTC	FINISH
PL3EO12ANO	12"	Clear Anodized
PL3EO12BRZ	12"	Dark Bronze Anodized
PL3EO12BS	12"	Brushed Stainless Steel
PL3EO12PS	12"	Polished Stainless Steel
PL3EO12SB	12"	Satin Brass
PL3EO12PB	12"	Polished Brass

**Back To Back Handles**

**Glass Hole Required:** 5/8" Diameter

**Construction:** 1" Diameter Stainless Steel or Brass Tubing

**Glass Thickness:** 3/8" to 3/4"

Extra Bolts Included for 1-3/4" Aluminum Door

**Bolt Spec:** M8x1.25

3mm Hex Key / Allen Wrench Included